

YNGK6
YNGL6

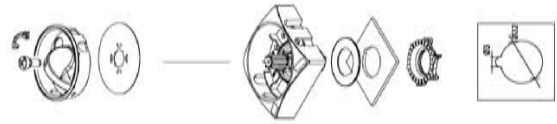

YNGT6
YNGY6



YNGT4
YNGY4

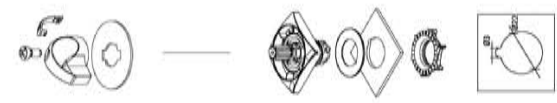

YNLUK7
YNLU7

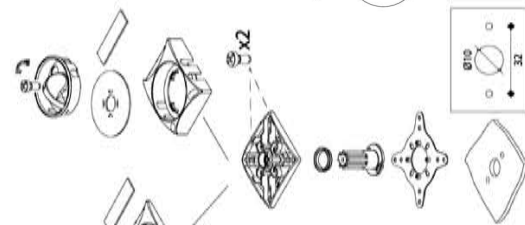

YNLU7
YNLUY7



YNLUK6
YNLU6

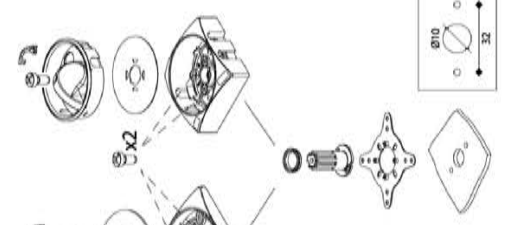

YNLU6
YNLUY6



YNLU4
YNLUY4

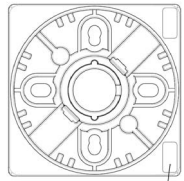
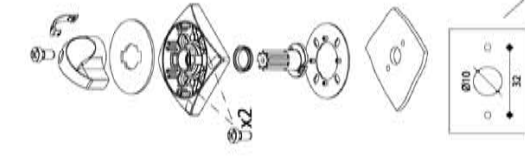

CEI EN 60947-3

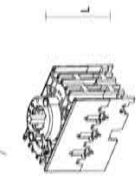

XNA...G ②
XNF...G

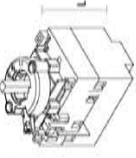

KNZ...G ①

L-(mm)	62	62
	KNZ	XNA 16-32A XNF

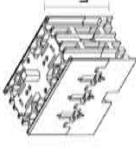

XNA...R ②
XNF...R

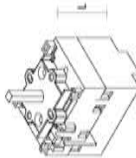

KNZ...R ①

L-(mm)	53	53
	KNZ	XNA 16-32A XNF

UL MARKING

- ① Use Fuses only, break all lines and same polarity. Suitable for use on a circuit capable of delivering not more than 10 KA rms symmetrical amperes, 600Vac, when protected by class J or CC fuses of 30A. Use 75°C copper (Cu) conductor only and wires No. 10 AWG, stranded or solid.
- ② Suitable for use on a circuit capable of delivering not more than 10 KA rms symmetrical amperes, 600Vac, when protected by listed cartridge fuses, nonrenewable (JDDZ) class J, time delay fuse. Use 60/75°C copper (Cu) conductor only and wire ranges No. 1-10 AWG, stranded or solid.

YNUT4
YNUY4

YNUT6
YNUY6

YNUK6
YNUK6
YNUY6

YNUT7
YNUY7

YNUK7
YNUY7
YNUK7
YNUY7

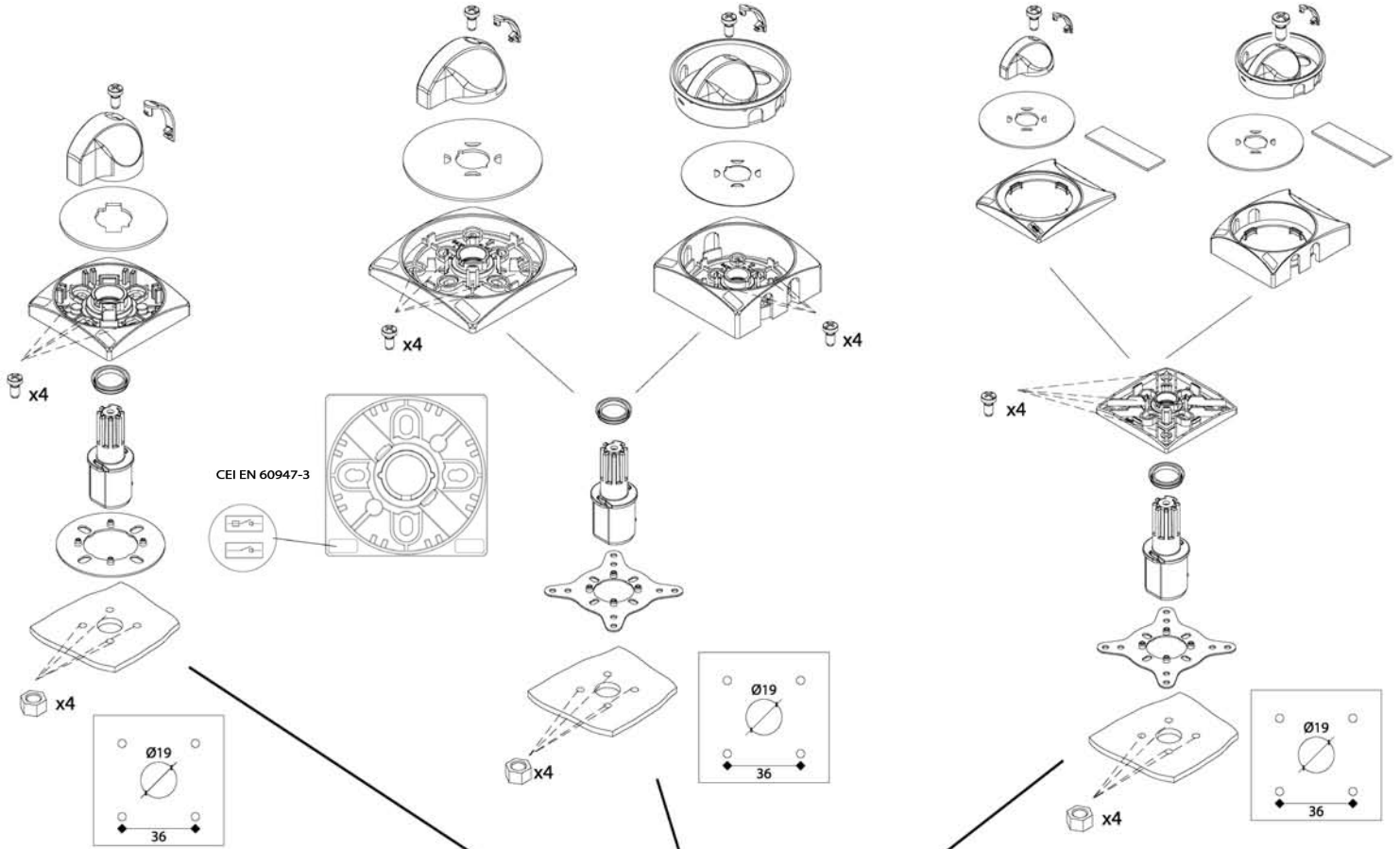

L= (mm)	KNZ	XNA 16+32A XNF	XNA 50+100A
H=100mm	min	188	202
	max	198	212
H=150mm	min	238	252
	max	248	262
H=200mm	min	288	292
	max	298	302

L= (mm)	KNZ	XNA 16+32A XNF	XNA 50+100A
1	min	108	122
	max	118	132
2	min	133	147
	max	143	157
3	min	158	172
	max	168	182
max 4	min	183	197
	max	193	207

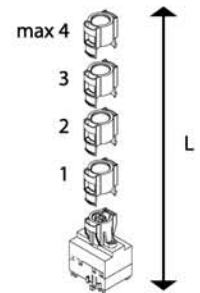
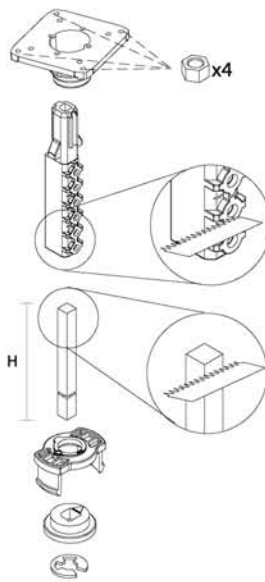
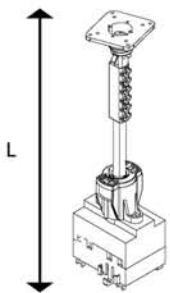

L= (mm)	KNZ	XNA 16+32A XNF	XNA 50+100A
min	83	83	97
max	93	93	107

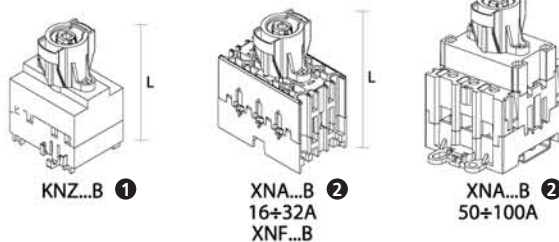

UL MARKING

① Use Fuses only, break all lines and same polarity. Suitable for use on a circuit capable of delivering not more than 10 KA rms symmetrical amperes, 600Vac, when protected by class J or CC fuses of 30A. Use 75°C copper (Cu) conductor only and wires No. 10 AWG, stranded or solid.

② Suitable for use on a circuit capable of delivering not more than 10 KA rms symmetrical amperes, 600Vac, when protected by listed cartridge fuses, nonrenewable (JDDZ) class J, time delay fuse. Use 60/75°C copper (Cu) conductor only and wire ranges No. 1-10 AWG, stranded or solid.

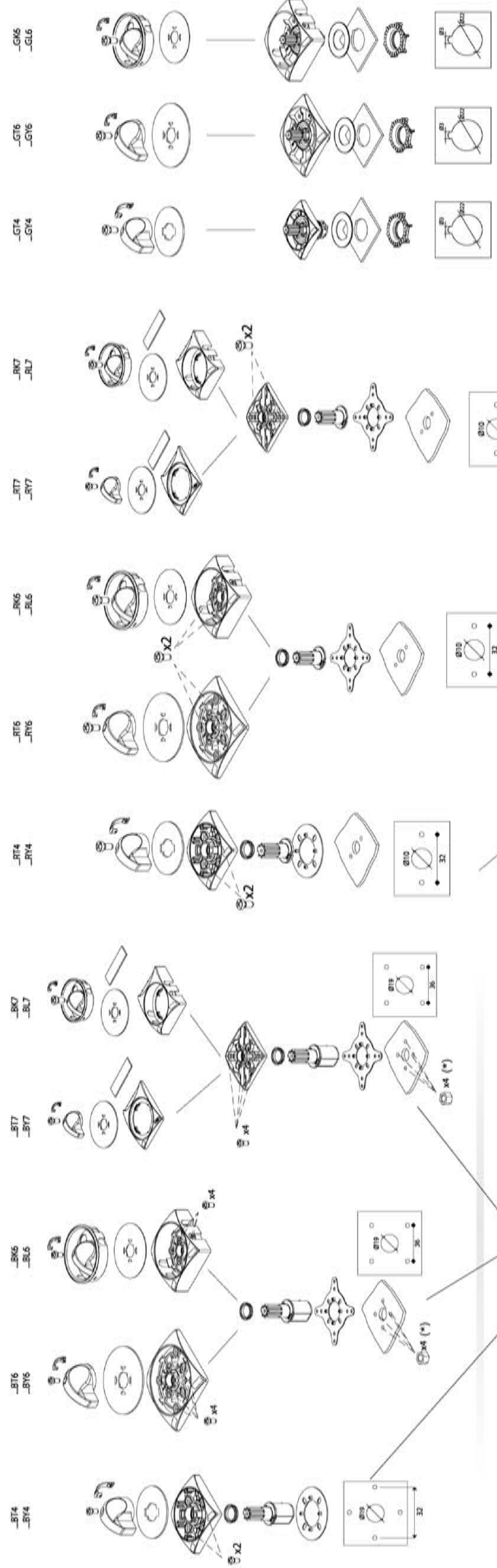

N°	CN012 CN016 CN020				CN025 CN032			
	1	2	3	4	1	2	3	4
1	MIN 100	113	125	127	107	123	139	16
2	MIN 126	138	150	132	117	133	149	16
3	MIN 151	163	175	157	142	158	174	16
4	MIN 176	188	200	182	167	183	199	16
MAX	186	198	210	192	177	193	209	16

L = mm

H	L	CN012 CN016 CN020			CN025 CN032		
		1	2	3	1	2	3
115	MIN 167	179	191	12	173	189	205
	MAX 244	256	268	250	266	282	16
165	MIN 244	256	268	12	300	316	332
	MAX 344	356	368	273	289	305	16
215	MIN 344	356	368	12	350	366	382
	MAX 444	456	468				

H - L = mm

(*) Montare 4 dadi

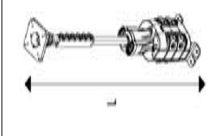
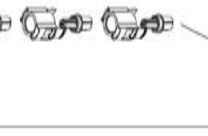
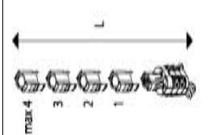

L (mm)	1	2	3	+
CN012				
CN016				
CN020	47	59	71	12
CN025				
CN032	53	65	85	+16

L (mm)	1	2	3	+
CN012				
CN016				
CN020	38	50	62	12
CN025				
CN032	44	60	76	+16

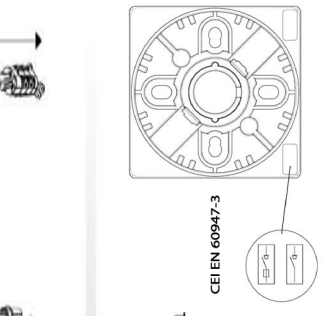

L (mm)	1	2	3	+
CN012	76	89	100	+12
CN016				
CN020	85	96	110	
CN025				
CN032	95	112	128	+16

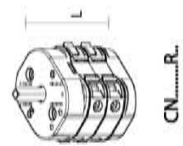
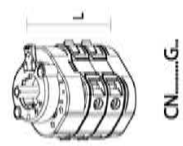

UL MARKING

Suitable for use on circuits capable of delivering not more than 5000 rms symmetrical amperes, 600Vac maximum, use fuses only. Minimum enclosure size: 215mm x 235mm x 85mm (W x H x D)

WIRE SIZE	CN012 - CN016	CN020	CN025 - CN032
	16-12 AWG	16-10 AWG	16-8 AWG

