

Solid State Relays Accessories Types RP...M1: DIN EN Mounting Interface Module

CARLO GAVAZZI



- PCB mounted AC Solid State Relay with DIN EN rail adaptor
- LED indication
- DC control input
- Width: 12.5 mm
- Adaptor suitable for rail types DIN EN 50022 and DIN EN 50035
- IP 20 Protection

Product Description

The DIN adaptor base houses the circuit of the interface module. The device includes input and output terminals and a user selected PCB Solid State Relay. The interface has

built-in LED status indication for control input. The module is an ideal interface between PLC or other logic controls and the AC load.

Ordering Key

RP1A23D5 M1

PCB Solid State Relay
Interface Module
Number of relay units

General Specifications

Operational voltage	250 VAC
Operational current	5 A eff.
Control voltage	Refer to PCB SSR Datasheet
Operating temperature	-20° to +70°C (-4° to 158°F)

Housing Specifications

Weight of module base	Approx. 14 g
Weight of module base with PCB Solid State Relay	Approx. 35 g
Module base material	Polyamide 6.6, self-extinguishing UL 94 V-0
Module Colour	Green
Control terminal	
Mounting screws	M 3
Mounting torque	≤ 0.5 Nm
Power terminal	
Mounting screws	M 3
Mounting torque	≤ 0.5 Nm
Max. wire sections	
Stranded wire	2.5 mm ² (13AWG)
Rigid wire	4.0 mm ² (11AWG)

Dimensions

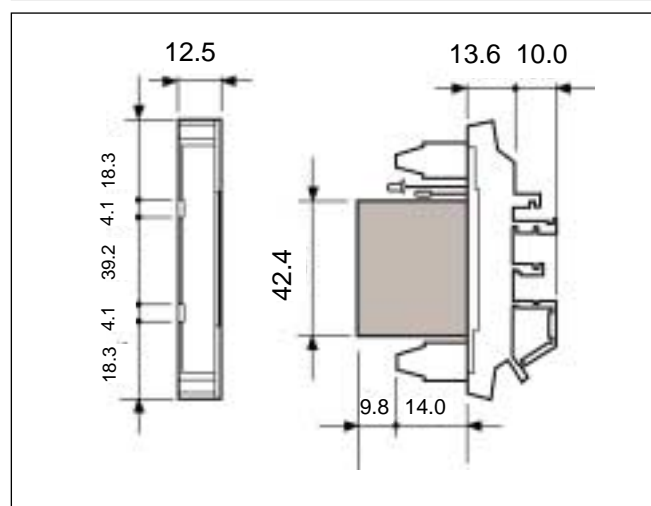

Wiring Diagram

